

Shifting Lever (2-WAY RELEASE)

IMPORTANT NOTICE

- Contact the place of purchase or a distributor for information on installation, adjustment, and replacement of the products which are not found in the user's manual. A dealer's manual for professional and experienced bicycle mechanics is available on our website (<https://si.shimano.com>).

For safety, be sure to read this "user's manual" thoroughly before use, follow it for correct use, and store it so that it can be referenced at any time.

The following instructions must be observed at all times in order to prevent personal injury and physical damage to equipment and surroundings. The instructions are classified according to the degree of danger or damage which may occur if the product is used incorrectly.

DANGER	Failure to follow the instructions will result in death or serious injury.
WARNING	Failure to follow the instructions could result in death or serious injury.
CAUTION	Failure to follow the instructions could cause personal injury or physical damage to equipment and surroundings.

Important Safety Information

WARNING

- Do not disassemble or modify the product. This may cause the product to not operate correctly, and you may suddenly fall and be seriously injured.

Notice

- Be sure to keep turning the crank during lever operation.
- Products are not guaranteed against natural wear and deterioration from normal use and aging.
- For maximum performance we highly recommend SHIMANO lubricants and maintenance products.

Regular Inspections Before Riding the Bicycle

Before riding the bicycle, check the following items. If any problems are found, consult your place of purchase or a distributor.

- Is gear shifting carried out smoothly?
- Are the levers securely installed to the handlebar?
- Do any abnormal noises occur during operation?
- Is the lever pad free from abnormal wear, rattling, and other abnormalities? (For models where a pad is attached to the lever.)

Names of parts

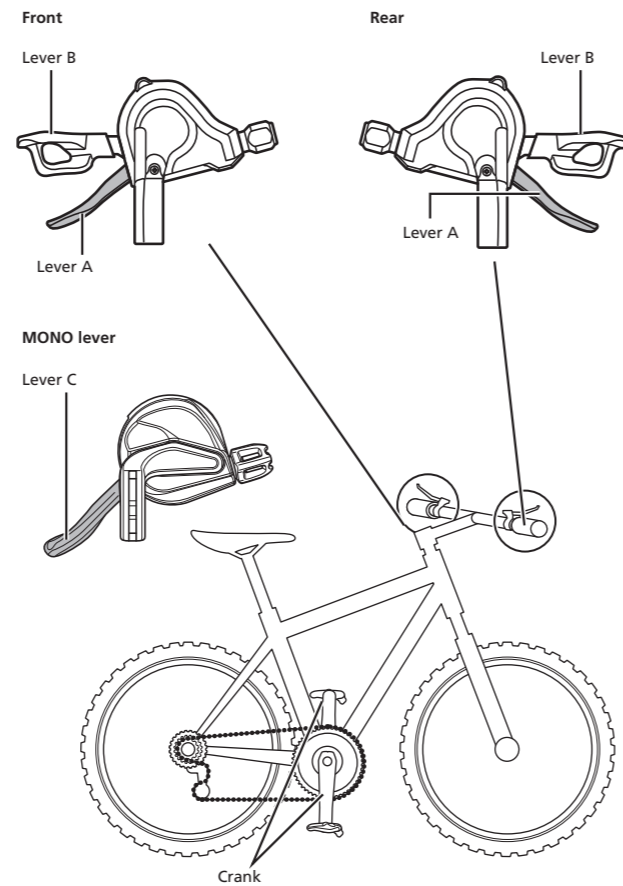

How to operate

Gear shifting operations

Be sure to keep turning the crank during lever operation.

Caution on operation

After shifting is completed, both levers A and B return to their initial position.

Right hand lever operation

The number of sprocket shifts depends on the lever stroke. To shift one sprocket, move the lever to position (1). To shift two sprockets, move the lever to position (2).

- Lever A: Shifts from the smallest to largest sprocket side

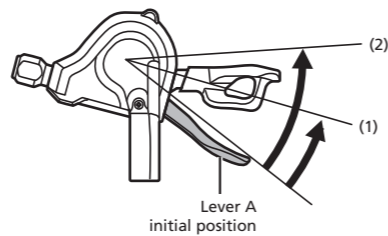

(1): Shifts one sprocket

Example: From the 3rd to 4th sprocket

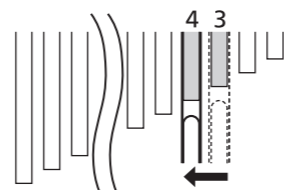

(2): Quick-shifts two sprockets

Example: From the 3rd to 5th sprocket

- Lever B: Shifts from the largest to smallest sprocket side

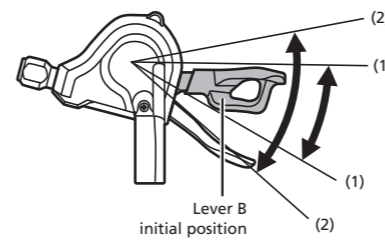

Gears can be shifted by pushing or pulling the lever. Some models have two-step gear shifting.

Example: From the 4th to 3rd sprocket

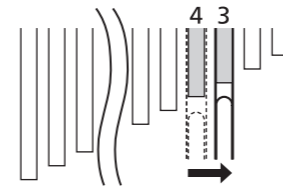

Left hand lever operation

- Lever A: Shifts from the smallest to largest chainring side

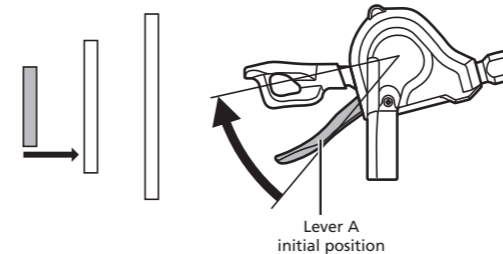

- Lever B: Shifts from the largest to smallest chainring side

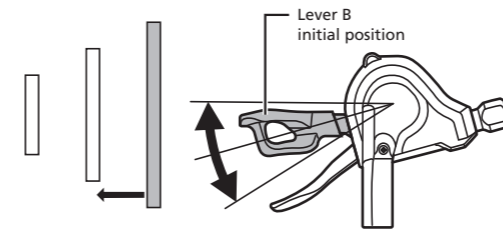

Gears can be shifted by pushing or pulling the lever.

Operation (MONO lever front side)

Operate one lever.

Gear shifting operations

Be sure to keep turning the crank during lever operation.

Monolever operation

- Lever C-1: Shifts from the smallest to largest chainring

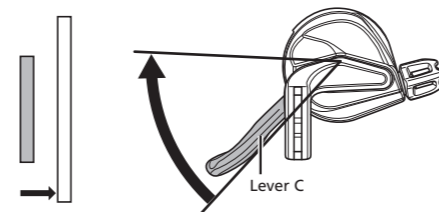

- * After shifting, the lever is kept in position C-2.

- Lever C-2: Shifts from the largest to smallest chainring

Gears can be shifted by pushing or pulling the lever.
* After shifting, the lever returns to position C-1.

SHIMANO

SHIMANO NORTH AMERICA BICYCLE, INC.
One Holland, Irvine, California 92618, U.S.A. Phone: +1-949-951-5003

SHIMANO EUROPE B.V.
High Tech Campus 92, 5656 AG Eindhoven, The Netherlands Phone: +31-402-612222

SHIMANO INC.
3-77 Oimatsu-cho, Sakai-ku, Sakai City, Osaka 590-8577, Japan